

Dyna-King ARISTOCRAT

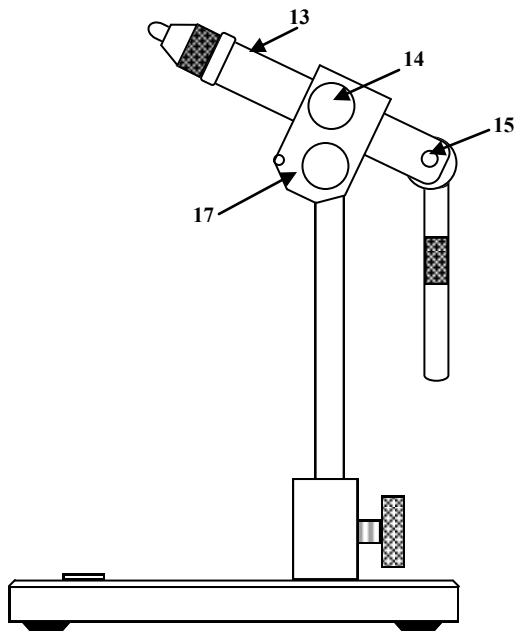

ARISTOCRAT Parts List:

1. Jaws
2. Forcing Cone
3. Adaptor
4. Cam Handle
5. Serial Number
6. Shaft
7. Base column
8. Base Lock Screw
9. Large Pedestal Base
10. Base Feet
11. Name Plate
12. Vise Body
13. Tension Screw
14. Cam Pin
15. Set Screw

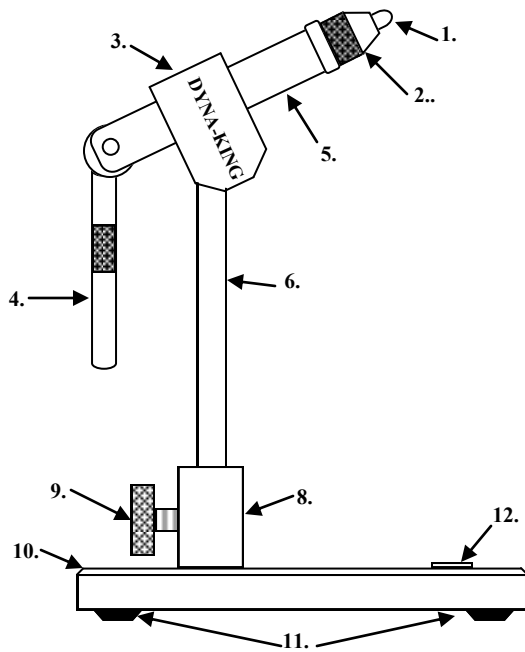

DYNA-KING, INC.
597 SANTANA DRIVE, UNIT A
CLOVERDALE, CA 95425, USA
Toll Free (800) 396-2546
Phone (707) 894-5566
Fax (707) 894-5990
Website: www.dyna-king.com
Email: info@dyna-king.com

ARISTOCRAT Information:

To change the vise to either angle, 30 ° or 90°, loosen and remove the Lock Screw (#17). Lift the Adaptor (#3) off of the vise Shaft (#6). Insert the Shaft into desired position. Insert the Lock Screw, into the appropriate threaded hole position, and tighten until it holds the Adaptor snug to the shaft. If you feel a slight wobble you may need to back out the Lock Screw & check that the Lock Screw tip is tightening flush against the flat section of the shaft. Be sure to not cross thread the Adaptor. If the Screw feels to tight going in, stop back it out & try again.

Tension on the hook can be achieved by adjusting the Forcing Cone (#2). To tighten, or loosen, the grip of the Jaws on the hook, the Cam Handle must first be raised, so that the Jaws will be in the open position. Screw or unscrew the Forcing Cone only enough so as that the Jaws will hold the hook securely. ***Over tightening the forcing Cone, or adjusting the Cone while the cam is in the down position, may cause the Jaws and/or Forcing Cone, to lock and possibly remain closed.**

To clean & maintain the vise, periodically wipe down with a soft cloth & light machine oil, or a lubricant spray. It is important to occasionally grease the inside of the Forcing Cone (# 2) & the outside of the Jaws (#1) , with a marine boat grease, available at your local auto parts store.